

ILLUMIClean™



USER'S GUIDE 68G9 SERIES 220-240V



3 Safety Instructions

4 Product View

5-6 Assembly

7-9 Operations

10-12 Maintenance and Care

13 Troubleshooting

14 Consumer Services

15 Replacement Parts

16 Warranty

Thanks for buying a BISSELL IllumiClean™ Canister Vacuum

We're glad you purchased a BISSELL IllumiClean canister vacuum. Everything we know about floor care went into the design and construction of this complete, high-tech home cleaning system.

Your BISSELL canister vacuum is well made, and we back it with a limited two year warranty. We also stand behind it with a knowledgeable, dedicated Consumer Services department, so, should you ever have a problem, you'll receive fast, considerate assistance.

My great-grandfather invented the floor sweeper in 1876. Today, BISSELL is a global leader in the design, manufacture, and service of high quality homecare products like your BISSELL canister vacuum .

Thanks again, from all of us at BISSELL.

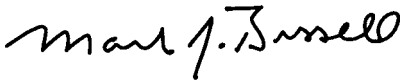

Mark J. Bissell
President and Chief Executive Officer

IMPORTANT SAFETY INSTRUCTIONS

When using an electrical appliance, basic precautions should be observed, including the following:

READ ALL INSTRUCTIONS BEFORE USING YOUR CANISTER VACUUM.

⚠ WARNING: To reduce the risk of fire, electric shock, or injury:

- Use indoors only.
- For dry pick up only.
- Do not leave machine when it is plugged in.
- Do not use with damaged cord or plug.
- If appliance is not working as it should, has been dropped, damaged, left outdoors, or dropped into water, return it to a service agent.
- Do not handle unit with wet hands.
- Do not pull or carry by cord, use cord as a handle, close door on cord, pull cord around sharp corners or edges, run appliance over cord, or expose cord to heated surfaces.
- Do not unplug by pulling on cord. Unplug by grasping plug.
- Do not run appliance over cord.
- Do not handle plug or appliance with wet hands.
- Do not expose hair, loose clothing, fingers or body parts to openings or moving parts.
- Do not pick up hot or burning objects such as cigarettes, matches, or hot ashes.
- Do not pick up flammable or combustible materials (lighter fluid, petrol, kerosene, etc.) or use in the presence of explosive liquids or vapour.
- Do not use appliance in an enclosed space filled with vapours given off by oil base paint, paint thinner, some moth proofing substances, flammable dust, or other explosive or toxic vapours.
- Not intended for use by persons (including children) with reduced sensory or mental capabilities, or lack of experience and knowledge, unless they have been given supervision or instruction concerning use of the appliance by a person responsible for their safety
- Young children should be supervised to ensure that they do not play with the appliance.
- Remove plug from electrical outlet before cleaning or maintaining the appliance.
- If the supply cord is damaged, it must be replaced by the manufacturer or its service agent in order to avoid a hazard.
- Do not pick up toxic material (chlorine bleach, ammonia, drain cleaner, petrol, etc.).
- Do not use for any purpose other than described in this User's Guide.
- Use only manufacturer's recommended attachments.
- Do not use with any opening blocked; keep free of dust, lint, hair, and anything that may reduce air flow.
- Keep appliance on a level surface.
- Turn off all controls before unplugging.
- Be extra careful when cleaning stairs.
- This appliance is provided with double insulation. Use only identical replacement parts.
- Do not use without the dust bag and filters in place.
- Pay close attention when working around children.

SAVE THESE INSTRUCTIONS.

THIS MODEL IS FOR HOUSEHOLD USE ONLY.

IMPORTANT

FOR OPERATION ON A 220-240 VOLT A.C. 50/60 Hz POWER SUPPLY ONLY.

If your appliance is fitted with a nonrewireable BS 1363 plug it must not be used unless a 13 amp (ASTA approved to BS 1362) fuse is fitted in the carrier contained in the plug. (Spare may be obtained from your BISSELL supplier). If for any reason the plug is cut off, it must be disposed of, as it is an electric shock hazard should it be inserted into a mains socket.

Product view



Upholstery Tool



Crevice Tool



Dusting Brush



Tool Caddy



CAUTION:

Do not plug in your vacuum until you are familiar with all instructions and operating procedures.

Assembling your vacuum

1. Connect swivel hose by squeezing both locking buttons and inserting it into the suction opening on the canister. Once the swivel hose is inserted in the suction opening, release the locking buttons.
2. Connect telescoping extension wand to the handle end of the flex hose. Twist slightly to tighten.
3. Attach the tool holder to the telescoping extension wand and insert the tools into the holder.
4. Connect floor nozzle to the end of the telescoping extension wand. Twist slightly to tighten.



WARNING:

Plastic film can be dangerous. To avoid danger of suffocation, keep away from babies and children.

1.



2.



3.



4.



Assembling your vacuum

5. Once assembled, you can store your vacuum in one of two positions:

A. Storing in the in-use position:

1. To store with the floor nozzle attached, insert the storage clip (located on the back of the floor nozzle) into the storage slot on the rear of the vacuum.
2. To store without the floor nozzle attached, insert the storage clip (located on the bottom of the telescoping extension wand) into the storage slot on the rear of the vacuum.

B. Storing in the upright position:

1. To store with the floor nozzle attached, stand the vacuum in the upright position and insert the storage clip (located on the back of the floor nozzle) into the storage slot on the bottom of the vacuum.
2. To store without the floor nozzle attached, stand the vacuum in the upright position and insert the storage clip (located on the bottom of the telescoping extension wand) into the storage slot on the bottom of the vacuum.

Storing in the in-use position

A1.



A2.



Storing in the upright position

B1.



B2.



Operations

Power cord

The power cord is located at the rear of the vacuum. Gently pull out the power cord, watching for the yellow line. Stop pulling the power cord once the yellow line is visible. There is also a red line, which indicates the end of the usable cord. Do not pull the power cord out beyond the red line.

Automatic cord rewind

Your vacuum is equipped with an automatic cord rewind. When cleaning is finished, press the power button OFF and grasp the plug to disconnect from the electrical outlet. Hold the plug and press the automatic cord rewind button to rewind the cord automatically.

Power button

Turn the power on or off by pressing lightly downward on the power button (⓪).

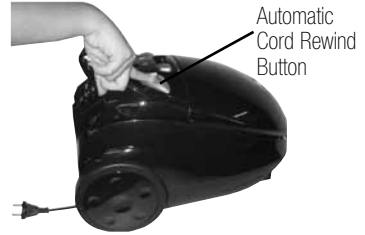

⚠ CAUTION:
Be careful to avoid injury as cord retracts very quickly.

⚠ CAUTION:
Before using your vacuum, make sure that the dust bag and all filters (pre-motor and post-motor) are in place. Do not operate your vacuum without the dust bag and filters.

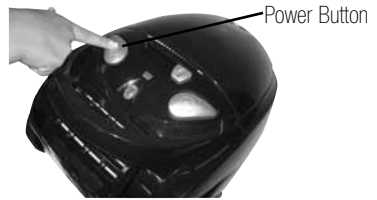

Operations

Special tools

Your BISSELL IllumiClean is not only a powerful carpet and rug vacuum cleaner, it's also a versatile bare floor vacuum cleaner and above floor vacuum cleaner when you select one of the special tools.

Floor nozzle:

Use to vacuum carpets, rugs and bare floors. Swivel head turns to get into tight spaces and fits under cabinets.

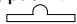
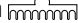
1. To vacuum carpets and rugs, push the brush switch to the carpet position . This will pull the brushes up into the floor nozzle.
2. To vacuum bare floors, push the brush switch to the bare floor position . This will extend the brushes down from the floor nozzle.

Dusting brush:

Use the dusting brush to dust furniture, blinds, books, lamps, shelves and baseboards.

Upholstery tool:

Use the upholstery tool to clean curtains, draperies, cushions and fabrics.

NOTE: Use the air flow regulator to reduce air flow as needed when using the upholstery tool.

Crevice tool:

Use the crevice tool in tight, narrow spaces.

Tip:

Before cleaning under low furniture, check area first for objects that might harm the unit or block the hose.

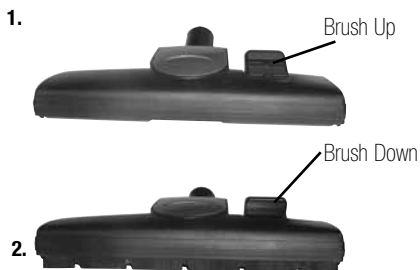

Tip:

Hair, string and small objects can block the hose and tools. Check them occasionally for obstructions.

Operations

Variable suction power control

The variable suction power control is located on the top of the vacuum. Slide the control toward the larger dots for maximum suction. Slide the control toward the smaller dots to minimize suction for lightly soiled areas or delicate fabrics.



Air flow regulator

Open the air flow regulator by sliding the regulator back towards the handle to an open position to reduce suction for delicate fabrics.

Close the air flow regulator by sliding the regulator down to the closed position for full suction.

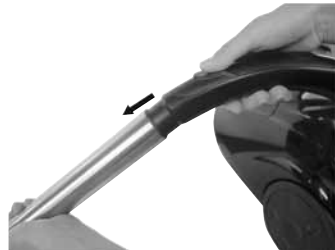

High filtration dust bag

The BISSELL IllumiClean features a non-woven, high filtration dust bag that captures more fine dust than traditional paper dust bags, giving off less dust emissions. It also holds more fine dust particles, giving you longer lasting suction power.

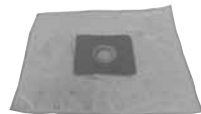

Bag change indicator

The bag change indicator is located between the power button and the automatic cord rewind button. If the bag change indicator turns orange while you are vacuuming, the dust bag needs to be replaced. The dust bag may appear to be full or only partially full depending upon the type of debris picked up. Fine particles can block the airflow in the dust bag and reduce suction before the dust bag is full. If the bag change indicator remains orange, even after changing the dust bag, turn the vacuum off and check for a clog in the hose or tools.



Note: The indicator may turn orange when using the tools due to the restricted airflow. This does not necessarily mean that the dust bag is full. If the indicator does not turn off once the tool is removed, check for a clog in the hose/tools or replace the dust bag.

Maintenance and care

Dust bag replacement

1. Unplug the vacuum from electrical outlet.
2. Open the dust bag compartment by lifting up on the latch on the door on the front of the vacuum.
3. Lift out the dust bag holder and dust bag.
4. Release the dust bag from the holder by pressing the dust bag holder clip and pulling the dust bag out of the holder. Discard the used dust bag.
5. Slide the new dust bag into the holder by inserting the dust bag into the tabs located at the bottom of the holder. Then press the dust bag holder clip, insert the dust bag and release the dust bag holder clip to hold the dust bag in place.
6. Place holder and new dust bag back into the dust bag compartment, making sure the entire bag is tucked in below the seal gasket.
7. Close dust bag compartment door and press down gently until it locks into place.

NOTE: The dust bag compartment door will not close without the dust bag in place.



WARNING:

To reduce the risk of electric shock, turn power switch OFF and disconnect plug from electrical outlet before performing maintenance or troubleshooting checks.

Maintenance and care

Cleaning the pre-motor filter

The pre-motor filter protects the motor from dirt and dust particles.

1. Unplug the vacuum from electrical outlet.
2. Open the dust bag compartment by lifting up on the latch on the door at the front of the vacuum. Lift out the dust bag holder and dust bag.
3. Remove the filter frame from the filter holder by grasping the lip of the frame and pulling up.
4. Remove the filter from the filter frame and clean by hand washing in warm water. A mild detergent can be used if desired. Allow the filter to air dry thoroughly before replacing.
5. Place the filter back into the filter frame and replace back into the filter holder.
NOTE: The filter frame should be placed so the protective frame is visible.
6. Place dust bag holder and dust bag into the dust bag compartment, making sure the entire bag is tucked in below the seal gasket.
7. Close dust bag compartment door and press down gently until it locks into place.

NOTICE:

This product is intended for household use only and not for commercial or industrial use. Vacuuming of dust from products like plaster, concrete or ashes will damage the motor and void the warranty.

Washable Pre-Motor Filter

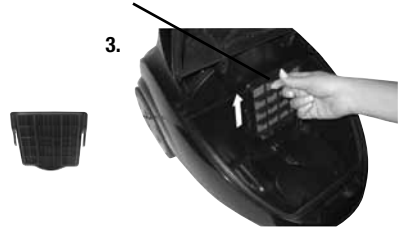

Tip:

For maximum cleaning performance, check the filters often and clean or replace if necessary.



WARNING:

Do not operate cleaner with damp or wet filters or without all filters in place.

Maintenance and care

Replacing the post-motor HEPA media filter

The post-motor HEPA media filter assists in the filtration process to return clean air to the room.

1. Unplug the vacuum from electrical outlet.
2. Remove the filter door (located on the rear of the vacuum) by pulling up on the filter door latch.
3. Remove the post-motor HEPA media filter by grasping the lip of the filter frame and pulling up.
4. Replace the post-motor HEPA media filter with a new filter.

NOTE: The post-motor filter is a white, pleated HEPA media filter. This filter is NOT washable and must be replaced when it becomes dirty.

5. Replace the filter door by inserting the two tabs at the top of the filter door and pushing down on the bottom of the filter door.



Troubleshooting



WARNING:

To reduce the risk of electric shock, turn power OFF and disconnect plug from electrical outlet before performing maintenance or troubleshooting.

Vacuum cleaner won't run

Possible causes

1. Vacuum cleaner is not plugged in
2. Power button is not pressed down

Remedies

1. Check electrical plug
2. Press power button down

Vacuum cleaner won't pick up or low suction

Possible causes

1. Tools, flex hose and/or telescoping extension wand are blocked
2. Filters are dirty
3. Dust bag is full
4. Swivel hose not securely attached to suction opening
5. Crack or hole in flex hose
6. Air flow regulator or variable suction power control is set to open or minimum setting

Remedies

1. Remove each part and check for blockages
2. Check and clean or replace pre-motor and post-motor filters
3. Replace with new dust bag
4. Make sure swivel hose is locked into suction opening
5. Check hose and replace if needed
6. Change to closed or maximum setting

Visible dust escaping from vacuum

Possible causes

1. Dust bag is full
2. Filters missing or installed incorrectly
3. Filters are dirty
4. Flex hose is blocked
5. Swivel hose not securely attached to suction opening
6. Crack or hole in flex hose

Remedies

1. Replace with new dust bag
2. Check pre-motor and post-motor filter for correct installation
3. Check and clean or replace pre-motor and post-motor filters
4. Remove hose and check for blockages
5. Make sure swivel hose is locked into suction opening
6. Check hose and replace if needed

Other maintenance or service not included in the manual should be performed by an authorized service representative.

Thank you for selecting a BISSELL product.

Please do not return this product to the store.

BISSELL Consumer Services

If your BISSELL product should require service:

In the UK, Australia, New Zealand, the Middle East or Africa, call BISSELL Consumer Services at the numbers below and we will give you the location of a BISSELL Authorized Service Center in your area. For all other countries, contact your local in country distributor for questions, service, or repair.

If you have questions about your warranty or need replacement parts please contact the numbers below.

For UK inquiries:

Monday - Thursday 9 am — 5 pm
Friday 9 am — 4 pm

BISSELL Homecare (Overseas) Inc.

The Boat Yard
105 Straight Road
Old Windsor
Berkshire, SL4 2SE
United Kingdom
Telephone: 0870-225-0109

For New Zealand inquiries:

Monday - Friday 9 am — 5 pm

Parex Industries Ltd.

5 Tolich Place
Henderson 0610
Auckland
New Zealand
Telephone: 0800-247-735

For all other inquiries:

Monday - Friday 8 am — 4 pm

BISSELL Homecare, Inc.

PO Box 1888
Grand Rapids, MI 49501 USA
Telephone: 01-616-453-4451
Fax: 01-616-453-1383

For Australian inquiries:

Monday - Friday 9 am — 5 pm

BISSELL AUSTRALIA PTY LIMITED

Unit 35
15 Ricketts Road
Mount Waverley, Victoria 3149
Australia
Telephone: 1-800-811-183

For Middle East & Africa inquiries:

Sunday - Thursday 8 am — 5 pm

BISSELL Middle East & Africa

P.O. Box 61286
Jebel Ali Free Zone
Dubai
United Arab Emirates
Telephone: 971-4-881-8597
Fax: 971-4-881-8598

Or visit the BISSELL website - www.bissell.com

When contacting BISSELL, have model number of unit available.

Please record your Model Number: _____

Please record your Purchase Date: _____

Note: Please keep your original sales receipt. It provides proof of date of purchase in the event of a warranty claim. See Warranty on page 16 for details.

Please do not return this product to the store.

Replacement parts - BISSELL IllumiClean

Item	Part No.	Part Name
1	203-7270	Dust Bag (3pk)
2	203-7268	Pre-Motor Filter
3	203-7269	Post-Motor HEPA Media Filter
4	203-7267	Floor Nozzle
5	203-7257	Flexible Hose with Handle
6	203-7256	Telescoping Extension Wand
7	203-7273	Upholstery Brush
8	203-7272	Dusting Brush
9	203-7271	Crevice Tool
10	203-7274	Tool Holder

1



2



3



4



5



6



7



8



9



10



Warranty - BISSELL IllumiClean Canister Vacuum

This warranty gives you specific legal rights, and you may also have other rights which may vary from country to country. If you need additional instruction regarding this warranty or have questions regarding what it may cover, please contact BISSELL Consumer Services by telephone, or regular post as described below, or contact your local in country distributor.

Limited Two Year Warranty

Subject to the *EXCEPTIONS AND EXCLUSIONS identified below, BISSELL Homecare, Inc., will replace (with new or remanufactured components), at BISSELL's option, free of charge from the date of purchase by the original purchaser, for two years any defective or malfunctioning part do to manufacturers defect.

This warranty applies to product used for personal, and not commercial or rental service. This warranty does not apply to fans or routine maintenance components such as filters, belts, or brushes. Damage or malfunction caused by negligence, abuse, or use not in accordance with the User's Guide is not covered.

For UK inquiries:

Monday - Thursday 9 am — 5 pm
Friday 9 am — 4 pm

BISSELL Homecare (Overseas) Inc.

The Boat Yard
105 Straight Road
Old Windsor
Berkshire, SL4 2SE
United Kingdom
Telephone: 0870-225-0109

For New Zealand inquiries:

Monday - Friday 9 am — 5 pm

Parex Industries Ltd.

5 Tolich Place
Henderson 0610
Auckland
New Zealand
Telephone: 0800-247-735

For all other inquiries:

Monday - Friday 8 am — 4 pm

BISSELL Homecare, Inc.

PO Box 1888
Grand Rapids, MI 49501 USA
Telephone: 01-616-453-4451
Fax: 01-616-453-1383

BISSELL HOME CARE INC. IS NOT LIABLE FOR INCIDENTAL OR CONSEQUENTIAL DAMAGES OF ANY NATURE ASSOCIATED WITH THE USE OF THIS PRODUCT. BISSELL'S LIABILITY WILL NOT EXCEED THE PURCHASE PRICE OF THE PRODUCT.

***EXCEPTIONS AND EXCLUSIONS FROM THE TERMS OF THE LIMITED WARRANTY**

THIS WARRANTY IS EXCLUSIVE AND IN LIEU OF ANY OTHER WARRANTIES EITHER ORAL OR WRITTEN. ANY IMPLIED WARRANTIES WHICH MAY ARISE BY OPERATION OF LAW, INCLUDING THE IMPLIED WARRANTIES OF MERCHANTABILITY AND FITNESS FOR A PARTICULAR PURPOSE, ARE LIMITED TO THE TWO YEAR DURATION FROM THE DATE OF PURCHASE AS DESCRIBED ABOVE.

For Australian inquiries:

Monday - Friday 9 am — 5 pm

BISSELL AUSTRALIA PTY LIMITED

Unit 35
15 Ricketts Road
Mount Waverley, Victoria 3149
Australia
Telephone: 1-800-811-183

For Middle East & Africa inquiries:

Sunday - Thursday 8 am — 5 pm

BISSELL Middle East & Africa

P.O. Box 61286
Jebel Ali Free Zone
Dubai
United Arab Emirates
Telephone: 971-4-881-8597
Fax: 971-4-881-8598



©2009 BISSELL Homecare, Inc.
Grand Rapids, Michigan
All rights reserved. Printed in Korea
Part Number 110-4123
Rev 5/09
Visit our website at:
www.bissell.com

